

UNIT, DIRECT SUPPORT, AND GENERAL SUPPORT MAINTENANCE  
REPAIR PARTS AND SPECIAL TOOLS LIST  
TRUCK, 5-TON, 6X6, M809 SERIES TRUCKS (DIESEL)

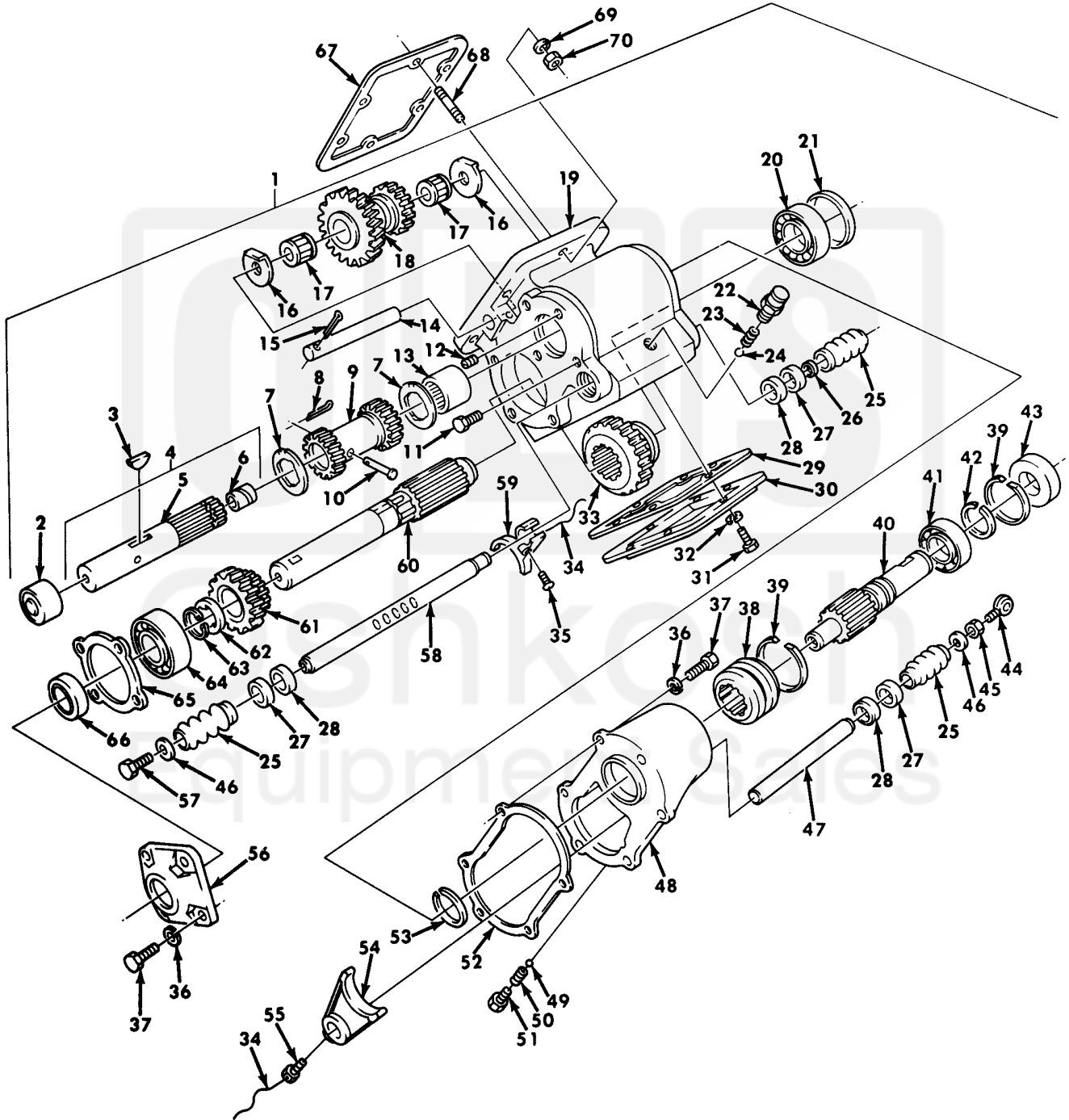

Figure 418. Transmission Power Takeoff Assembly and Mounting Hardware.

| (1)<br>ITEM<br>NO  | (2)<br>SMR<br>CODE | (3)<br>NSN       | (4)<br>CAGEC | (5)<br>PART<br>NUMBER | (6)<br>DESCRIPTION AND USABLE ON CODE (UOC)        | (7)<br>QTY |
|--|--------------------|------------------|--------------|-----------------------|--|------------|
| GROUP 2004 POWER TAKEOFF ASSEMBLY                                  |                    |                  |              |                       |  |            |
| FIG. 418 TRANSMISSION POWER TAKEOFF ASSEMBLY AND MOUNTING HARDWARE |                    |                  |              |                       |  |            |
| 1  | PAFFF              | 2520-00-740-9589 | 19207        | 7409589               | POWER TAKEOFF, TRANS.....<br>UOC: 620, 627, 633    | 1          |
| 2  | PAFZZ              | 3110-00-183-6723 | 24617        | 713421                | . BEARING.....<br>UOC: 620, 627, 633               | 1          |
| 3  | PAFZZ              | 5315-00-058-8581 | 96906        | MS35756-109           | . KEY, WOODRUFF.....<br>UOC: 620, 627, 633         | 1          |
| 4  | PAFZZ              | 2520-00-740-9594 | 19207        | 7409594               | . SHAFT REVERSE GEAR.....<br>UOC: 620, 627, 633    | 1          |
| 5  | XAFZZ              |                  | 19207        | 10900574              | . . SHAFT.....<br>UOC: 620, 627, 633               | 1          |
| 6  | PAFZZ              | 3120-00-737-3115 | 19207        | 7373115               | . . BEARING, SLEEVE.....<br>UOC: 620, 627, 633     | 1          |
| 7  | PAFZZ              | 5310-00-706-1281 | 19207        | 7061281               | . WASHER, THRUST.....<br>UOC: 620, 627, 633        | 2          |
| 8  | PAFZZ              | 5315-00-839-2326 | 96906        | MS24665-281           | . PIN, COTTER.....<br>UOC: 620, 627, 633           | 1          |
| 9  | PAFZZ              | 2520-00-740-9587 | 19207        | 7409587               | . GEAR REVERSE SHAFT.....<br>UOC: 620, 627, 633    | 1          |
| 10   | PAFZZ              | 5315-01-208-5492 | 19207        | 8728251               | . PIN, STRAIGHT, HEADED.....<br>UOC: 620, 627, 633 | 1          |
| 11   | PAFZZ              | 5306-00-226-4822 | 80204        | B1821BH031C050N       | . BOLT, MACHINE.....<br>UOC: 620, 627, 633         | 2          |
| 12   | PAFZZ              | 4730-00-018-9566 | 81348        | WW-P-471ACABCA        | . PLUG, PIPE.....<br>UOC: 620, 627, 633            | 1          |
| 13   | PAFZZ              | 3110-00-183-6723 | 96906        | MS17131-35            | . BEARING, ROLLER, NEED.....<br>UOC: 620, 627, 633 | 1          |
| 14   | PAFZZ              | 3040-00-706-1266 | 95019        | 9P21                  | . SHAFT, SHOULDERED.....<br>UOC: 620, 627, 633     | 1          |
| 15   | PAFZZ              | 5315-00-013-7258 | 96906        | MS24665-497           | . PIN, COTTER.....<br>UOC: 620, 627, 633           | 1          |
| 16   | PAFZZ              | 5310-00-753-8656 | 19207        | 7538656               | . WASHER, KEY.....<br>UOC: 620, 627, 633           | 2          |
| 17   | PAFZZ              | 3110-00-227-3074 | 19207        | 7538658               | . BEARING, ROLLER, JOUR.....<br>UOC: 620, 627, 633 | 2          |
| 18   | PAFZZ              | 3020-00-740-9586 | 19207        | 7409586               | . GEAR CLUSTER.....<br>UOC: 620, 627, 633          | 1          |
| 19   | PAFZZ              | 2520-00-706-1160 | 19207        | 7061160               | . CASE NAME PLATE.....<br>UOC: 620, 627, 633       | 1          |
| 20   | PAFZZ              | 3110-00-100-3119 | 60038        | 700080                | . CONE AND ROLLERS, TA.....<br>UOC: 620, 627, 633  | 1          |
| 21   | PAFZZ              | 2520-00-706-1265 | 19207        | 7061265               | . SPACER POWER TAKE O.....<br>UOC: 620, 627, 633   | 1          |
| 22   | PAFZZ              | 2520-00-104-4603 | 19207        | 5226140               | . RETAINER, SHIFTER SH.....<br>UOC: 620, 627, 633  | 1          |
| 23   | PAFZZ              | 5360-00-692-6128 | 19207        | 8331558               | . SPRING, HELICAL, COMP.....<br>UOC: 620, 627, 633 | 1          |
| 24   | PAFZZ              | 3110-00-100-6158 | 96906        | MS19059-2422          | . BALL, BEARING.....<br>UOC: 620, 627, 633         | 1          |
| 25   | PAOZZ              | 9390-00-706-1278 | 19207        | 7061278               | . BELLOWS, PROTECTION.....<br>UOC: 620, 627, 633   | 3          |
| 26   | PAOZZ              | 5310-00-740-9595 | 19207        | 7409595               | . WASHER, FLAT.....<br>UOC: 620, 627, 633          | 1          |
| 27   | PAOZZ              | 5330-00-737-6534 | 19207        | 7376534               | . RETAINER, PACKING.....<br>UOC: 620, 627, 633     | 3          |
| 28   | PAFZZ              | 5330-01-143-1211 | 19207        | 7061272               | . SEAL, PLAIN ENCASED.....<br>UOC: 620, 627, 633   | 3          |
| 29   | PAFZZ              | 5330-00-234-3317 | 19207        | 8327322               | . GASKET.....<br>UOC: 620, 627, 633                | 1          |

| (1)<br>ITEM<br>NO | (2)<br>SMR<br>CODE | (3)<br>NSN       | (4)<br>CAGEC | (5)<br>PART<br>NUMBER | (6)<br>DESCRIPTION AND USABLE ON CODE (UOC)                                     | (7)<br>QTY |
|-------------------|--------------------|------------------|--------------|-----------------------|---|------------|
| 30                | PAFZZ              | 5340-00-354-0771 | 19207        | 5323473               | .COVER,ACCESS.....<br>UOC: 620, 627, 633  | 1          |
| 31                | PAFZZ              | 5305-00-144-1495 | 19207        | 10910354              | .SCREW,MACHINE.....<br>UOC: 620, 627, 633                                       | 6          |
| 32                | PAFZZ              | 5310-00-627-6128 | 96906        | MS35335-35            | .WASHER,LOCK.....<br>UOC: 620, 627, 633   | 6          |
| 33                | PAFZZ              | 3020-00-318-0908 | 19207        | 7538671               | .GEAR,SPUR.....<br>UOC: 620, 627, 633   | 1          |
| 34                | MFFZZ              |                  | 96906        | MS20995F41XAR         | .WIRE,NONELECTRICAL MAKE FROM<br>WIRE,P/N MS20995F41.....<br>UOC: 620, 627, 633 | 1          |
| 35                | PAFZZ              | 5306-00-404-0075 | 19207        | 8344155               | .BOLT,MACHINE.....<br>UOC: 620, 627, 633  | 1          |
| 36                | PAFZZ              | 5310-00-407-9566 | 96906        | MS35338-45            | .WASHER,LOCK.....<br>UOC: 620, 627, 633   | 9          |
| 37                | PAFZZ              | 5306-00-225-8499 | 96906        | MS90725-34            | .BOLT,MACHINE.....<br>UOC: 620, 627, 633  | 9          |
| 38                | PAFZZ              | 2520-00-706-1210 | 19207        | 7061210               | .CLUTCH,SLIDING SLEE.....<br>UOC: 620, 627, 633                                 | 1          |
| 39                | PAFZZ              | 5325-00-706-1280 | 19207        | 7061280               | .RING,RETAINING.....<br>UOC: 620, 627, 633                                      | 2          |
| 40                | PAFZZ              | 3040-00-706-1211 | 95019        | 3P136                 | .SHAFT,SHOULDERED.....<br>UOC: 620, 627, 633                                    | 1          |
| 41                | PAFZZ              | 3110-00-144-8518 | 21450        | 700078                | .BEARING,BALL,ANNULA.....<br>UOC: 620, 627, 633                                 | 1          |
| 42                | PAFZZ              | 5325-01-125-6136 | 19207        | 7061277               | .RING,RETAINING.....<br>UOC: 620, 627, 633                                      | 1          |
| 43                | PAFZZ              | 5330-00-559-8733 | 19207        | 7061271               | .SEAL,PLAIN ENCASED.....<br>UOC: 620, 627, 633                                  | 1          |
| 44                | PFOZZ              | 5306-00-493-5315 | 95019        | 36P1                  | .BOLT,EYE.....<br>UOC: 620, 627, 633  | 1          |
| 45                | PAOZZ              | 5310-00-918-6921 | 96906        | MS35691-20            | .NUT,PLAIN,HEXAGON.....<br>UOC: 620, 627, 633                                   | 1          |
| 46                | PAOZZ              | 5310-00-080-6004 | 96906        | MS27183-14            | .WASHER,FLAT.....<br>UOC: 620, 627, 633   | 2          |
| 47                | PAFZZ              | 3040-00-706-1268 | 19207        | 7061268               | .SHAFT,SHOULDERED.....<br>UOC: 620, 627, 633                                    | 1          |
| 48                | XAFZZ              |                  | 19207        | 7061194               | .HOUSING.....<br>UOC: 620, 627, 633   | 1          |
| 49                | PAFZZ              | 3110-00-100-6155 | 96906        | MS19059-2418          | .BALL,BEARING.....<br>UOC: 620, 627, 633  | 1          |
| 50                | PAFZZ              | 5360-00-521-4784 | 19207        | 5214784               | .SPRING,HELICAL,COMP.....<br>UOC: 620, 627, 633                                 | 1          |
| 51                | PAFZZ              | 5365-00-769-6481 | 19207        | 7696481               | .PLUG,MACHINE THREAD.....<br>UOC: 620, 627, 633                                 | 1          |
| 52                | PAFZZ              | 5330-00-706-1270 | 19207        | 7061270               | .GASKET.....<br>UOC: 620, 627, 633  | 1          |
| 53                | PAFZZ              | 5325-00-706-1276 | 19207        | 7061276               | .RING,RETAINING.....<br>UOC: 620, 627, 633                                      | 1          |
| 54                | PAFZZ              | 2520-00-706-1274 | 19207        | 7061274               | .SHIFTER FORK,VEHICU.....<br>UOC: 620, 627, 633                                 | 1          |
| 55                | PAFZZ              | 5305-00-752-1058 | 19207        | 7521058               | .SETSCREW.....<br>UOC: 620, 627, 633  | 1          |
| 56                | PAFZZ              | 4730-00-626-2467 | 56442        | 2394T2                | .FLANGE,PIPE.....<br>UOC: 620, 627, 633   | 1          |
| 57                | PAFZZ              | 5305-00-269-3234 | 80204        | B1821BH038F075N       | .SCREW,CAP,HEXAGON H.....<br>UOC: 620, 627, 633                                 | 1          |
| 58                | PAFZZ              | 3040-00-740-9592 | 19207        | 7409592               | .SHAFT,SHOULDERED.....<br>UOC: 620, 627, 633                                    | 1          |
| 59                | XDFZZ              |                  | 19207        | 7061273               | .SHIFTER FORK,NONVEH.....<br>UOC: 620, 627, 633                                 | 1          |
| 60                | PAFZZ              | 2520-00-740-9593 | 19207        | 7409593               | .SHAFT OUTPUT.....<br>UOC: 620, 627, 633  | 1          |

| (1)<br>ITEM<br>NO | (2)<br>SMR<br>CODE | (3)<br>NSN       | (4)<br>CAGEC | (5)<br>PART<br>NUMBER | (6)<br>DESCRIPTION AND USABLE ON CODE (UOC)       | (7)<br>QTY |
|-------------------|--------------------|------------------|--------------|-----------------------|---|------------|
| 61                | PAFZZ              | 3020-00-740-9585 | 19207        | 7409585               | .GEAR CLUSTER.....<br>UOC: 620, 627, 633          | 1          |
| 62                | PAFZZ              | 3120-00-753-8661 | 19207        | 7538661               | .BEARING, WASHER, THRU.....<br>UOC: 620, 627, 633 | 1          |
| 63                | PAFZZ              | 5325-01-163-5018 | 19207        | 7538660               | .RING, RETAINING.....<br>UOC: 620, 627, 633       | 1          |
| 64                | PAFZZ              | 3110-00-555-7227 | 21450        | 714248                | .BEARING, BALL, ANNULA.....<br>UOC: 620, 627, 633 | 1          |
| 65                | PAFZZ              | 5330-00-532-3606 | 19207        | 5323606               | .GASKET.....<br>UOC: 620, 627, 633                | 1          |
| 66                | PAFZZ              | 5330-00-404-3210 | 19207        | 11640317              | .SEAL, PLAIN ENCASED.....<br>UOC: 620, 627, 633   | 1          |
| 67                | PAFZZ              | 5330-00-234-3317 | 19207        | 8327322               | GASKET.....<br>UOC: 620, 627, 633                 | 1          |
| 68                | PAFZZ              | 5307-00-011-3247 | 24617        | 113247                | STUD, PLAIN.....<br>UOC: 620, 627, 633            | 6          |
| 69                | PAFZZ              | 5310-00-637-9541 | 96906        | MS35338-46            | WASHER, LOCK.....<br>UOC: 620, 627, 633           | 6          |
| 70                | PAFZZ              | 5310-00-732-0559 | 96906        | MS51968-8             | NUT, PLAIN, HEXAGON.....<br>UOC: 620, 627, 633    | 6          |

END OF FIGURE

